

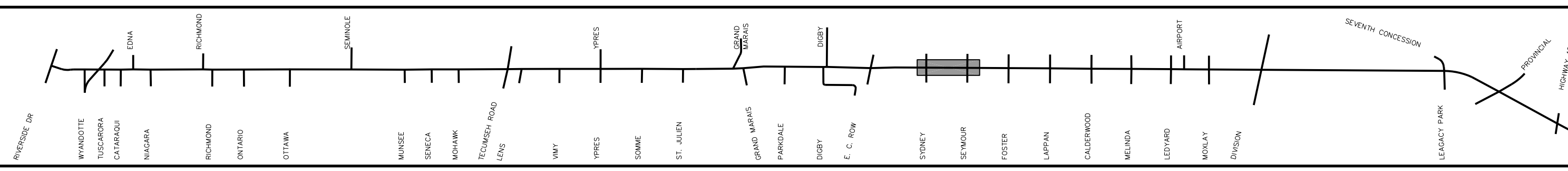

VIEW: SH2D  
 G:\CAD\96401\96401\_01.dwg 03/14/2002 08:06:56 AM EST

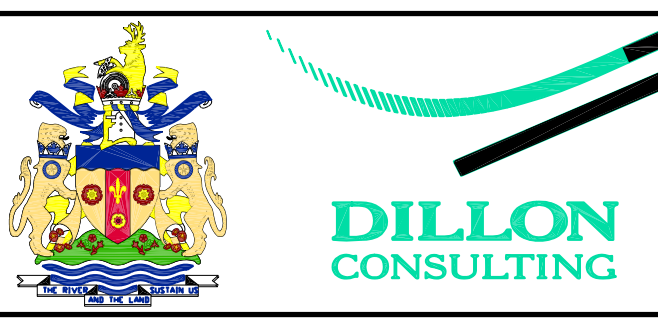
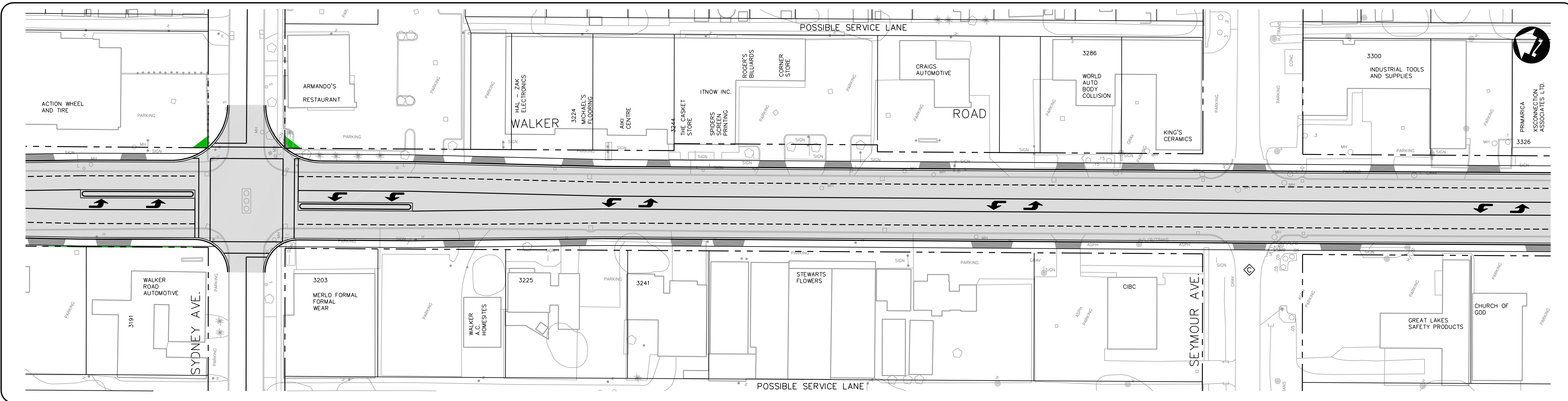

- NEW SIDEWALKS
- NEW PAVEMENT
- EASEMENT
- PROPERTY ACQUISITION
- CONCEPTUAL DRIVEWAY LOCATION

**LEGEND**

- ROAD CLOSURE (DETAILS TO BE DETERMINED)
- EXISTING TRAFFIC SIGNAL
- NEW TRAFFIC SIGNAL

SCALE: 1:500

MARCH, 2001

FIGURE 20

**WALKER ROAD CORRIDOR  
 GRAND MARAIS ROAD EAST IMPROVEMENTS  
 ENVIRONMENTAL STUDY REPORT  
 PREFERRED DESIGN**

