

TYPICAL CROSS SECTION

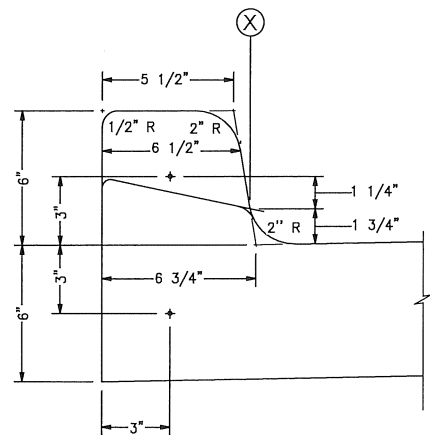

INTEGRAL BARRIER CURB

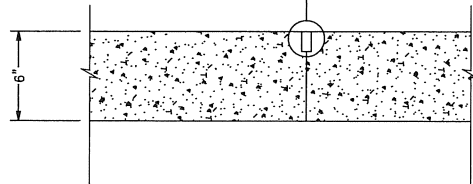
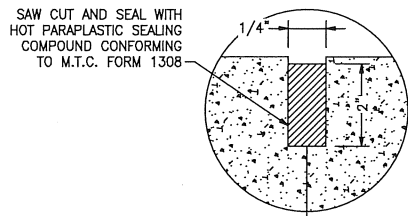

TYPE E LONGITUDINAL CONTRACTION JOINT

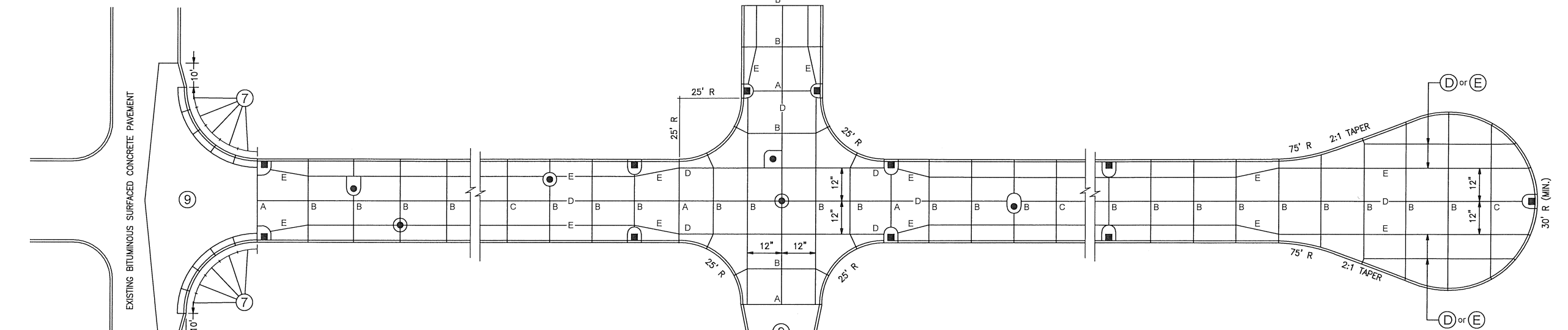

TYPICAL CATCH BASIN, MANHOLE AND UTILITY VALVE BOX-OUTS

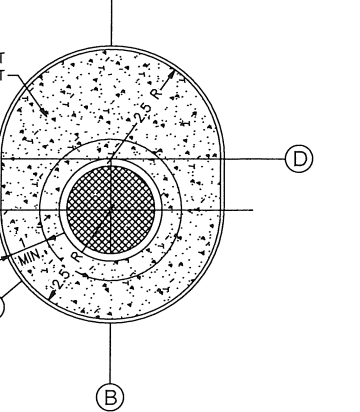
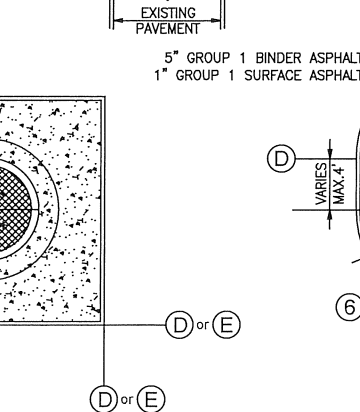
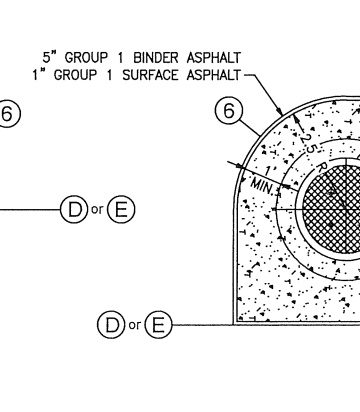
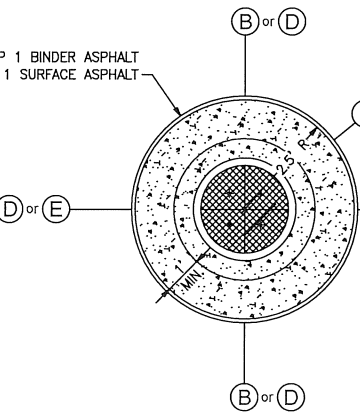
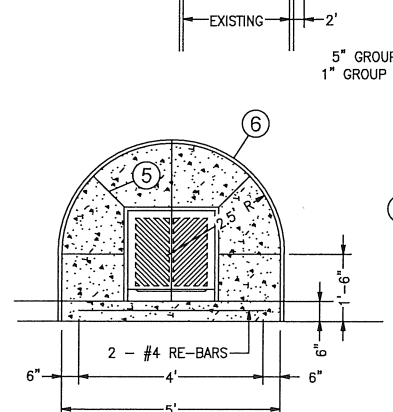

- NOTES:
- 1 ALL PREMOLDED JOINT FILLER SHALL CONFORM TO M.T.C. 1308
 - 2 SPACING OF TRANSVERSE JOINTS SHALL NOT EXCEED 16 FEET. PANEL AREA SHALL NOT EXCEED 225 SQ. FEET
 - 3 JOINT SPACING TO BE ESTABLISHED, WHERE POSSIBLE, TO PERMIT JOINT TO FALL ON CENTRE OF STRUCTURE.
 - 4 ANGLES BETWEEN PAVEMENT JOINTS MUST NOT BE LESS THAN 45°
 - 5 ISOLATED AREAS FOR CATCH BASINS ETC. TO BE INTERNALLY JOINTED USING 2 INCH DEEP, 1/4 INCH THICK PREMOLDED FILLER.
 - 6 ISOLATE ALL STRUCTURES, CATCH BASINS ETC. USING FULL DEPTH, 1/2 INCH THICK, PREMOLDED FILLER.
 - 7 JOINT SPACING FOR SEPARATE CURB AND GUTTER ON RADIUS SHALL NOT EXCEED 10 FEET.
 - 8 ALL WORK SHALL CONFORM TO CITY OF WINDSOR SPEC. S-7 & S-9.
 - 9 (A) A 6 INCH THICKNESS OF CONCRETE BASE WITH A MIN. 4 INCH OF G.B.C. 'A' TO BE PLACED ON TRANSITION TO NEW PAVEMENT. OLD BITUMINOUS SURFACE COURSE ASPHALT AS DIRECTED.
(B) LOCATION OF JOINTS IN BASE TO INTERCEPT JOINTS IN EXISTING ABUTTING PAVEMENT.

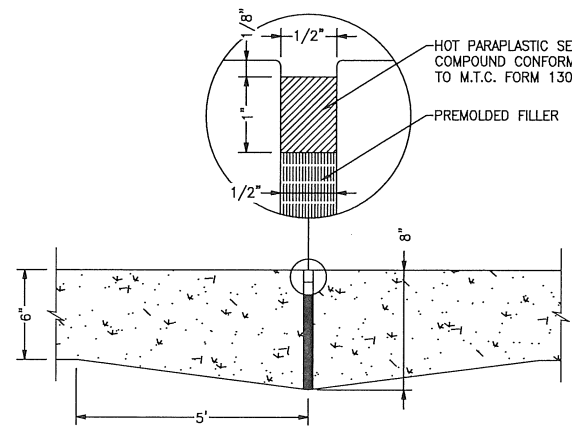

TYPE A TRANSVERSE EXPANSION

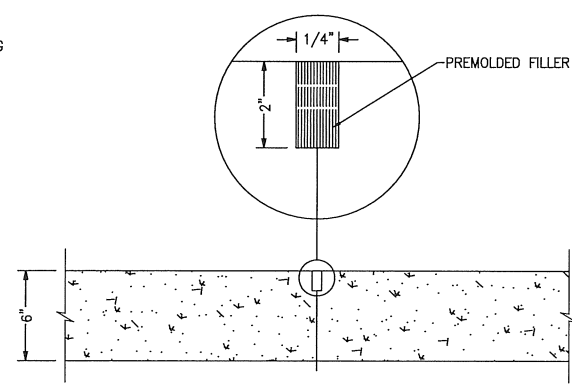

TYPE B TRANSVERSE CONTRACTION JOINT

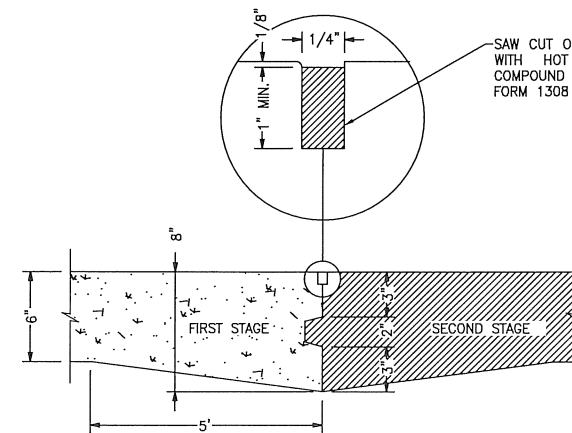

TYPE C TRANSVERSE CONSTRUCTION JOINT

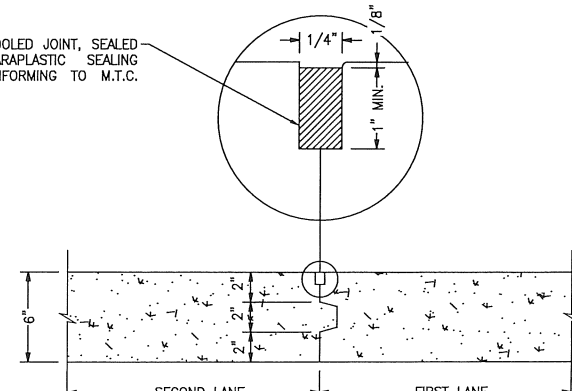

TYPE D LONGITUDINAL CONSTRUCTION JOINT

CITY OF WINDSOR
ENGINEERING DEPARTMENT

STANDARD CONCRETE DETAILS
FOR RESIDENTIAL PAVEMENTS

DR'N BY: LEB / ES / NB /A/C	DATE: FEB 1972
REVISION: NOV 2015 / DEC 2021	CH'KD BY: MC/ J.H
CH'KD BY: PJU	PASSED BY: P.J.U.

[Signature]
CITY ENGINEER

AS-211