

- LEGEND**
- DRAINAGE AREA BOUNDARY
 - GRAVEL ROAD DRAIN (TO BE ABANDONED)
 - - - GRAND MARAIS DRAIN, 3RD CONC. DRAIN, CABANA ROAD, MARENTETTE DRAIN & MERRIT DRAIN
 - ACCESS CULVERT

THE CORPORATION OF THE CITY OF WINDSOR - ENGINEERING DEPARTMENT
**Gravel Drain to be Abandoned from South of Grand Marais Road West
 Along South Cameron Boulevard and Howard Avenue to Cabana Road East**

SCALE: 1:10000	DATE: OCT 2023	REVISED: —	DWG. NO.
DWN BY: UT	CHKD BY: PJU / PM	REVISION NO.: —	C-3767

Kirk Tamm, Manager of Geomatics

DRAFT #1.
 CHECKED BY:

APPENDIX "A"
Drawing No. CC-1827

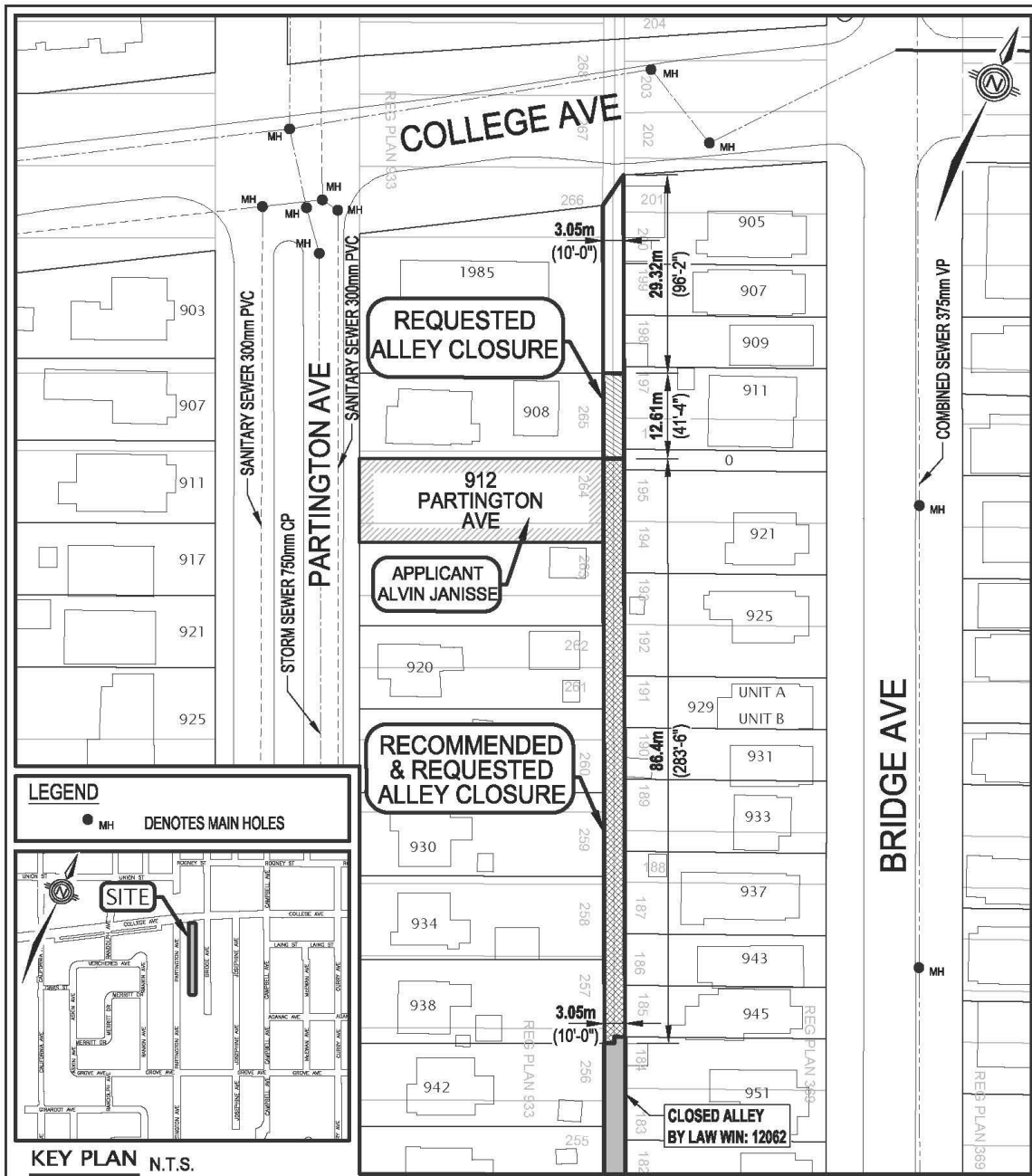

THE CORPORATION OF THE CITY OF WINDSOR - ENGINEERING DEPARTMENT Proposed Closure Of North/South Alley Between Partington Avenue And Bridge Avenue South Of College Avenue			
 Kirk Tamm, Manager of Geomatics	SCALE: 1:750	DATE: DECEMBER 2022	REVISED: .
	DWN BY: GP	CHKD BY: PJU / MM	REVISION NO.: .
			DWG. NO. CC-1827

APPENDIX "A"
Drawing No. CC-1829

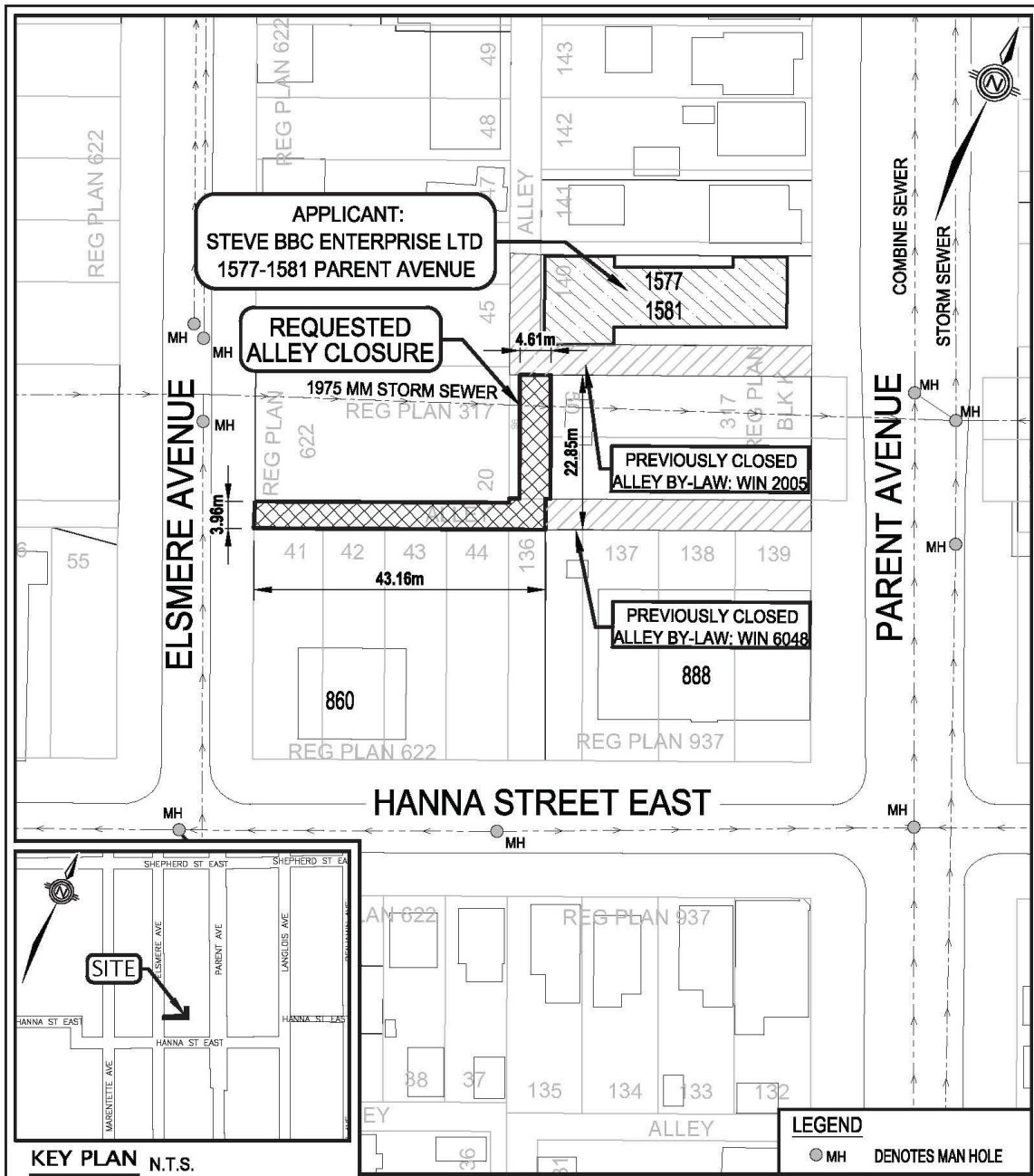

THE CORPORATION OF THE CITY OF WINDSOR - ENGINEERING DEPARTMENT Proposed Closure Part of The North/South & East/West Alley between Elsmere Avenue & Parent Avenue, North of Hanna Street East				
 Kirk Tamm, Manager of Geomatics	SCALE: 1:750	DATE: AUGUST 2023	REVISED: -	DWG. NO. CC-1829
	DWN BY: UT	CHKD BY: PJU / MM	REVISION NO.: -	

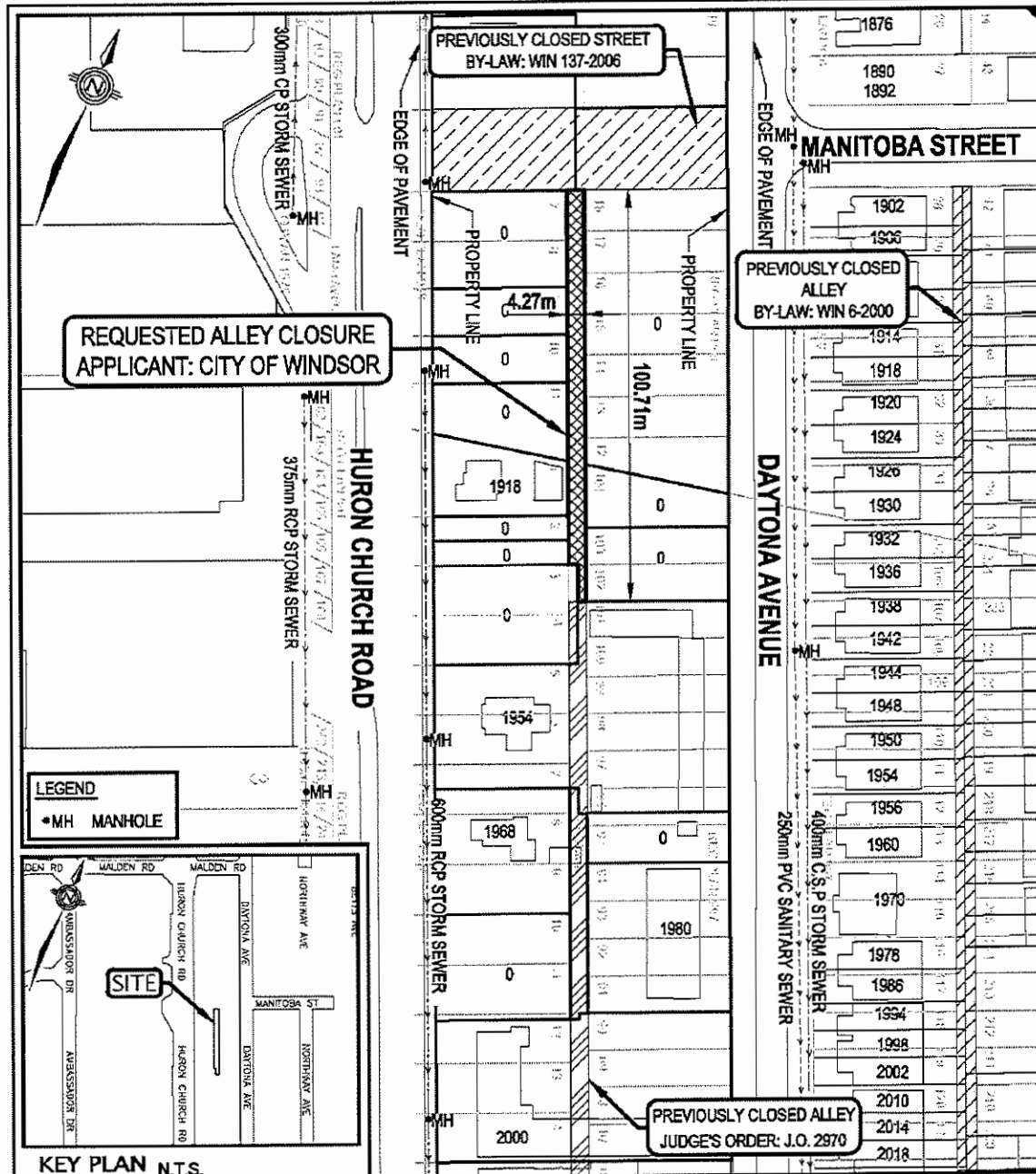

THE CORPORATION OF THE CITY OF WINDSOR - ENGINEERING DEPARTMENT

Closure of Part of the North/South Alley between Huron Church Road and Daytona Avenue, South of Manitoba Street

Kirk Tamm
 Kirk Tamm, Manager of Geomatics

SCALE: 1:1000	DATE: NOV 2023	REVISED: -
DWN BY: AZ	CHKD BY: PJU / BN	REVISION NO.: -

DWG. NO.
CC-1842

Appendix A
Lands to be Expropriated

Owner & Municipal Address	Land to be Expropriated	Type of Acquisition
Shree Nirmal Sai Motel Inc. 1425 Division Road	Part Lot 93, Concession 3, Sandwich East designated as Parts 6 and 7 on Plan 12R-29506, Windsor, being all of PIN 01561-5053 (LT)	Full Taking Fee Simple
2072820 Ontario Limited 2130 Division Road	Part of Lot 1033 on Registered Plan 1126, Sandwich East, Windsor, designated as Part 4 12R-29507, being Part of PIN 01350-0294 (LT)	Partial Taking Fee Simple
Crata Equities Limited 1400 Provincial Road	Part of Lot 15, Concession 5 Sandwich East designated as Part 5 on Plan 12R-29506, being Part of PIN 01294-0370 (LT)	Partial Taking Fee Simple
Happy Days Leisure Products Limited 1445 Cabana Road East	Part of Lot 15 Concession 5, Sandwich East designated as Part 4 on Plan 12R-29506, being Part of PIN 01294-0368 (LT)	Partial Taking Fee Simple
Paul Maurice Brazeau 1475 Cabana Road East	Part of Lot 15 Concession 5, Sandwich East designated as Part 3 on Plan 12R-29506, , being Part of PIN 01294-0366 (LT)	Partial Taking Fee Simple
Onkar Singh Nagra and Balbir Kaur Nagra 3863 Acorn Court	Part of Lot 136, Plan 12M-381, Windsor, designated as Parts 1 and 2 on Plan 12R-29506, being Part of PIN 01560—0243 (LT)	Partial Taking Fee Simple
Ann Anahid Zartarian, Mark Garo Zartarian, Shari Sue Goldberg, Michael Goldberg, Julia Alison Freedman and Eric Wirt Freedman 1805-1825 Division Road	Part of Lot 16, Concession 6, Sandwich East designated as Parts 5, 6, 7, 8 & 9 on Plan 12R-29505, Windsor, being Part of PIN 01560-0124 (LT)	Partial Taking Fee Simple

Home Depot Holdings Inc. 1925 Division Road	Part of Lot 16, Concession 6, Sandwich East designated as Parts 1, 2, 3 & 4 on Plan 12R-29505 being Part of PIN 01560-2598 (LT)	Partial Taking Fee Simple
Ishtar Holdings 1 Inc. 2025 Division Road	Part of Lot 16, Concession 6 Sandwich East designated as Part 3 on Plan 12R-29507, Windsor being Part of PIN 01560-0104 (LT)	Partial Taking Fee Simple
1307742 Ontario Inc., the successor corporation for 770007 Ontario Inc. 2225 Division Road	Part of Lot 16, Concession 6, Sandwich East, Windsor, designated as Parts 1 and 2 on Plan 12R-29507, being Part of PIN 01560-3005 (LT)	Partial Taking Fee Simple