

LEGEND:

- ==== CONTRACTION JOINT
- FULL DEPTH EXPANSION JOINT
- ▨ SEE NOTE 5 & 8 FOR DETERMINING THICKNESS OF CONCRETE

MORE THAN 600mm SEPARATION BETWEEN SIDEWALK AND BACK OF CURB

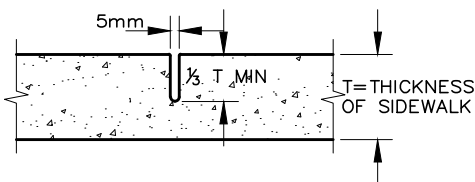

CONTRACTION JOINT

SPACED AT 2.4m (8') (OR AS DIRECTED BY CITY ENGINEER)

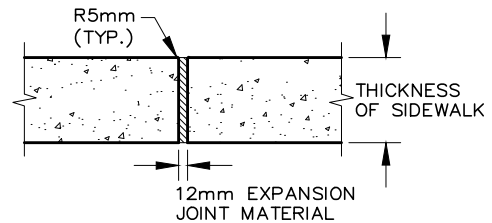

FULL DEPTH EXPANSION JOINT

SPACED AT 18.0m (59'-0") (UNLESS OTHERWISE SHOWN OR AS DIRECTED BY CITY ENGINEER)

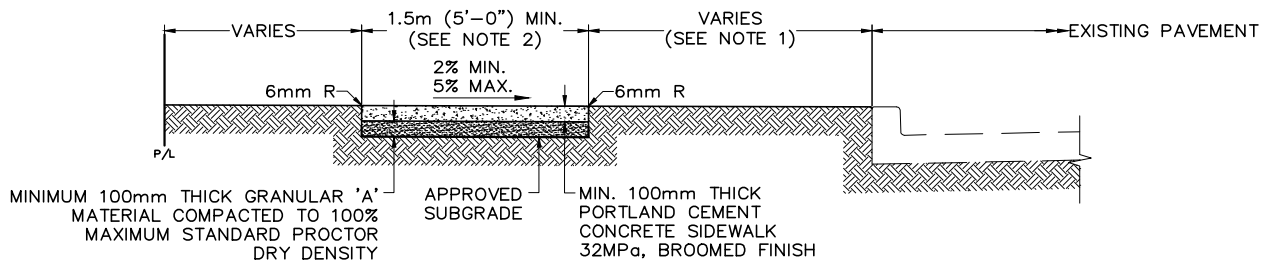

TYPICAL SIDEWALK CROSS SECTION

GENERAL NOTES:

1. Unless sidewalk abuts the curb, the distance between sidewalk and back of curb must be 600mm minimum.
2. Any sidewalk width exceeding 3m must have a centered longitudinal contraction joint. Maximum spacing between longitudinal contraction joints to be 1.5m.
3. Expansion joints are required at all fixed objects (poles, hydrants, manholes, structures, etc) and change in sidewalk direction.
4. All manholes, boxes, valves, etc. to match finished grade of sidewalk.
5. To be read in conjunction with AS-222, AS-401A, AS-402, AS-404 and Standard Specifications S-6.
6. All work within public right-of-way to be completed to City of Windsor Standards and to the satisfaction of the City Engineer.
7. Full depth expansion joints in the sidewalk are to be installed consistently at 18.0m unless an expansion joint will be located within a driveway, in which case an expansion joint shall be installed on either side of the driveway.
8. Where sidewalk crosses driveway the thickness of the concrete and granular base for sidewalk shall match the thickness of pavement and granular base specified in the appropriate driveway detail. Refer to AS-203, AS-204, AS-221, AS-222.

NOT TO SCALE

CITY OF WINDSOR ENGINEERING DEPARTMENT	
RESIDENTIAL CONCRETE SIDEWALK	
DR'N BY: BC, AC, UT, AZ	DATE: APR, 2004
REV. DATE: JAN, 2024	CH'KD BY (ENG): PM, JH
CH'KD BY (GEO/OPS): PJU, AL	PASSED BY: FM
_____ CITY ENGINEER	AS-401